

SUGGESTED PCB LAYOUT  
(COMPONENT SIDE)

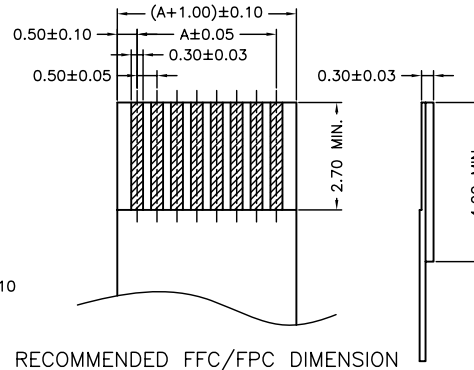

RECOMMENDED FFC/FPC DIMENSION

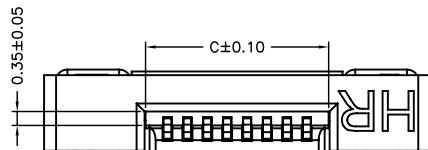
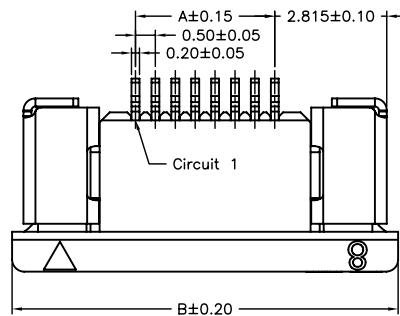
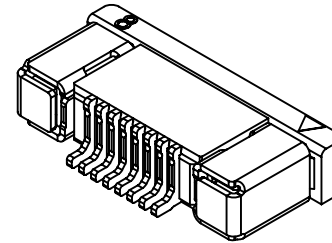
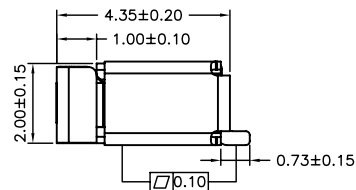
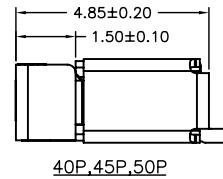
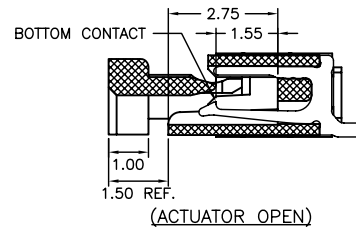

**SPECIFICATIONS**  
 Current Rating: 0.5A AC,DC  
 Voltage Rating: 50V AC,DC  
 Temperature Range: -25°C ~ +85°C  
 Contact Resistance: 30mΩ Max.  
 Insulation Resistance: 100MΩ Min.  
 Withstanding Voltage: 250V AC/minute  
 Contacts: Phosphor Bronze/Gold-flash 1u"  
 Solder Tabs: Brass/Gold-flash 1u"  
 Housing: Nylon 6T,UL94V-0,Natural(Beige)  
 Actuator: Nylon 6T,UL94V-0,Natural(Black)

Ordering Information & Dimensions

PART NO.	Dimensions			PART NO.	Dimensions		
	A	B	C		A	B	C
F0500WR-S-04PB	1.50	7.70	2.60	F0500WR-S-25PB	12.00	18.20	13.10
F0500WR-S-05PB	2.00	8.20	3.10	F0500WR-S-26PB	12.50	18.70	13.60
F0500WR-S-06PB	2.50	8.70	3.60	F0500WR-S-27PB	13.00	19.20	14.10
F0500WR-S-07PB	3.00	9.20	4.10	F0500WR-S-28PB	13.50	19.70	14.60
F0500WR-S-08PB	3.50	9.70	4.60	F0500WR-S-29PB	14.00	20.20	15.10
F0500WR-S-09PB	4.00	10.20	5.10	F0500WR-S-30PB	14.50	20.70	15.60
F0500WR-S-10PB	4.50	10.70	5.60	F0500WR-S-31PB	15.00	21.20	16.10
F0500WR-S-11PB	5.00	11.20	6.10	F0500WR-S-32PB	15.50	21.70	16.60
F0500WR-S-12PB	5.50	11.70	6.60	F0500WR-S-33PB	16.00	22.20	17.10
F0500WR-S-13PB	6.00	12.20	7.10	F0500WR-S-34PB	16.50	22.70	17.60
F0500WR-S-14PB	6.50	12.70	7.60	F0500WR-S-35PB	17.00	23.20	18.10
F0500WR-S-15PB	7.00	13.20	8.10	F0500WR-S-36PB	17.50	23.70	18.60
F0500WR-S-16PB	7.50	13.70	8.60	F0500WR-S-37PB	18.00	24.20	19.10
F0500WR-S-17PB	8.00	14.20	9.10	F0500WR-S-38PB	18.50	24.70	19.60
F0500WR-S-18PB	8.50	14.70	9.60	F0500WR-S-39PB	19.00	25.20	20.10
F0500WR-S-19PB	9.00	15.20	10.10	F0500WR-S-40PB	19.50	25.70	20.60
F0500WR-S-20PB	9.50	15.70	10.60	F0500WR-S-45PB	22.00	28.20	23.10
F0500WR-S-21PB	10.00	16.20	11.10	F0500WR-S-49PB	24.00	30.20	25.10
F0500WR-S-22PB	10.50	16.70	11.60	F0500WR-S-50PB	24.50	30.70	25.60
F0500WR-S-23PB	11.00	17.20	12.10	F0500WR-S-51PB	25.00	31.20	26.10
F0500WR-S-24PB	11.50	17.70	12.60				

				UNIT	SCALE	SHEET	TITLE:	
				mm		1 of 2	0.50mm PITCH	
				DRAWN BY		APPROVED BY		
				蕭惠風		董正一		
				2002.07.14		2002.07.15		
				GENERAL TOLERANCE				
B3	EN0912010589	2009.12.01	X. X±0.25	ANGLE±		90° SMT TYPE, ZIF, BOTTOM CONTACT STYLE		
B2	REVISE	2009.04.30						
B1	REVISE	2007.08.02						
B0	NEW RELEASE	2005.11.19	X. XX±0.15			DRAW NO. :		
REV.	DESCRIPTION	DATE	X. XXX±0.05			F0500WR-S-XPB		REV. B3

### 04~21 Contacts

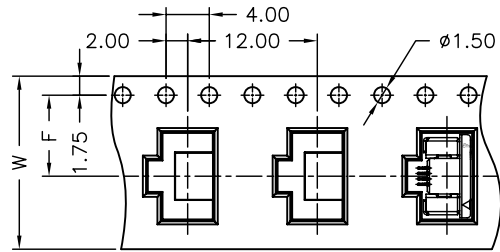

Unreeling direction →

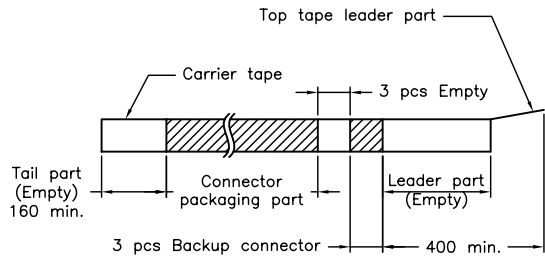
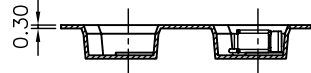

R0.85

1.50<sup>+0.10</sup><sub>-0</sub>

### 22~51 Contacts

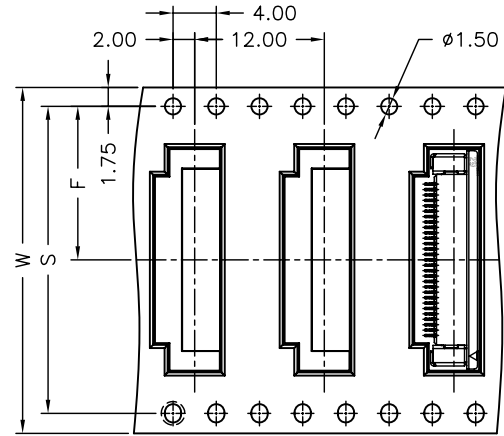

Unreeling direction →

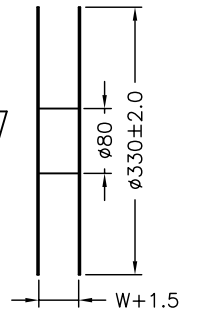
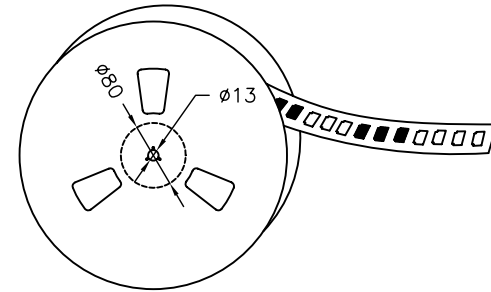
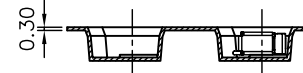

Number of Contacts	W±0.3	F±0.1	S±0.1	Q'ty/Reel	Number of Contacts	W±0.3	F±0.1	S±0.1	Q'ty/Reel
04P	16	7.50		1,500	25P	32	14.20	28.40	1,500
05P	16	7.50		1,500	26P	32	14.20	28.40	1,500
06P	24	11.50		1,500	27P	32	14.20	28.40	1,500
07P	24	11.50		1,500	28P	32	14.20	28.40	1,500
08P	24	11.50		1,500	29P	32	14.20	28.40	1,500
09P	24	11.50		1,500	30P	32	14.20	28.40	1,500
10P	24	11.50		1,500	31P	44	20.20	40.40	1,500
11P	24	11.50		1,500	32P	44	20.20	40.40	1,500
12P	24	11.50		1,500	33P	44	20.20	40.40	1,500
13P	24	11.50		1,500	34P	44	20.20	40.40	1,500
14P	24	11.50		1,500	35P	44	20.20	40.40	1,500
15P	24	11.50		1,500	36P	44	20.20	40.40	1,500
16P	24	11.50		1,500	37P	44	20.20	40.40	1,500
17P	24	11.50		1,500	38P	44	20.20	40.40	1,500
18P	24	11.50		1,500	39P	44	20.20	40.40	1,500
19P	24	11.50		1,500	40P	44	20.20	40.40	1,500
20P	24	11.50		1,500	45P	44	20.20	40.40	1,500
21P	24	11.50		1,500	49P	44	20.20	40.40	1,500
22P	32	14.20	28.40	1,500	50P	44	20.20	40.40	1,500
23P	32	14.20	28.40	1,500	51P	44	20.20	40.40	1,500
24P	32	14.20	28.40	1,500					

				UNIT	SCALE	SHEET	TITLE: 0.50mm PITCH FFC/FPC CONNECTOR 90° SMT TYPE, ZIF, BOTTOM CONTACT STYLE, TAPING SPEC.
				mm		2 of 2	
DRAWN BY		APPROVED BY		GENERAL TOLERANCE		DRAW NO. : F0500WR-S-XPB	
蕭惠風		董正一		2002.07.14 2002.07.15			
B2	EN0912010589	2009.12.01	X.X±0.25	ANGLE±			
B1	REVISE	2007.08.02	X.XX±0.15				
B0	NEW RELEASE	2005.11.19	X.XXX±0.05			REV. B2	
REV.	DESCRIPTION	DATE					