

① Board dimensions (top view)
Scale 3:1

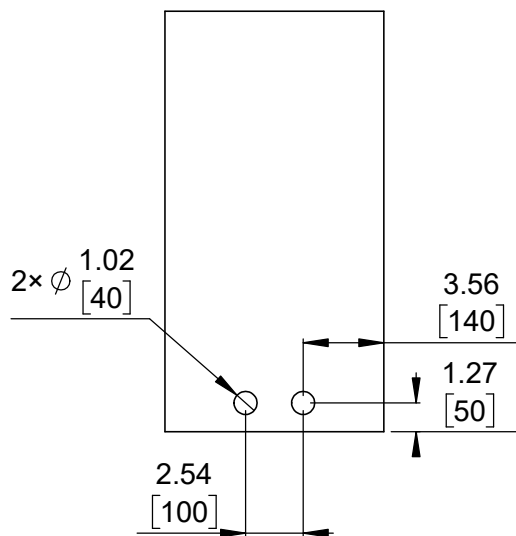

② Connector callouts (bottom view)
Scale 3:1

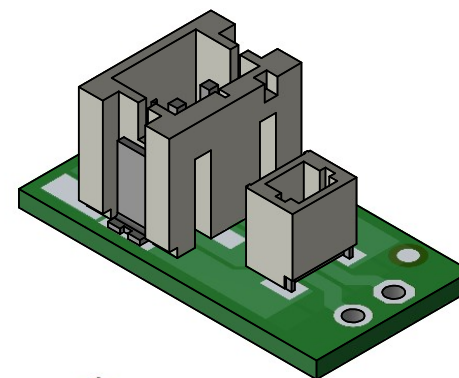

③ Isometric view
Scale 3:1

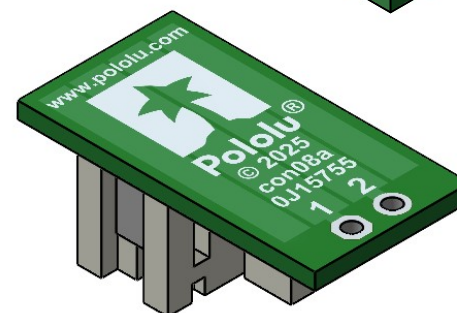

⑤ Actual size
Scale 1:1

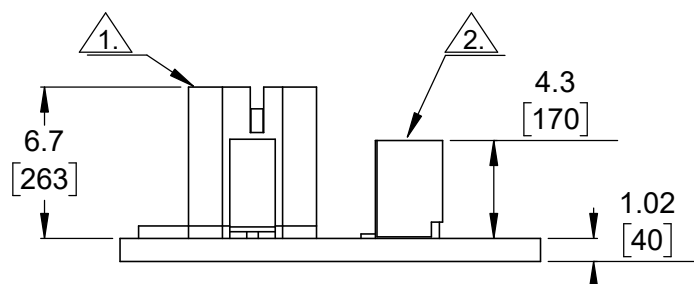

④ Profile
Scale 3:1

①. Top-entry, 2-pin male JST PH-style connector (2.0 mm pitch).

②. Top-entry, 2-pin male JST SH-style connector (1.0 mm pitch).
To get the specified scale, select 100% in print settings.

③. Drill location tolerance: ± 0.1 [± 5].

④. Board edge tolerance: ± 0.3 [± 10].

<https://www.pololu.com/product/5650>

Name:
Breakout for JST PH-Style Connector,
2-Pin Male Top-Entry, with SH

Item number:
5650

Drawing date:
18 August 2025

Dev code:
con08a

Units: mm
[mil]

Material:
mixed

Pololu
Robotics & Electronics
© 2025 Pololu Corporation

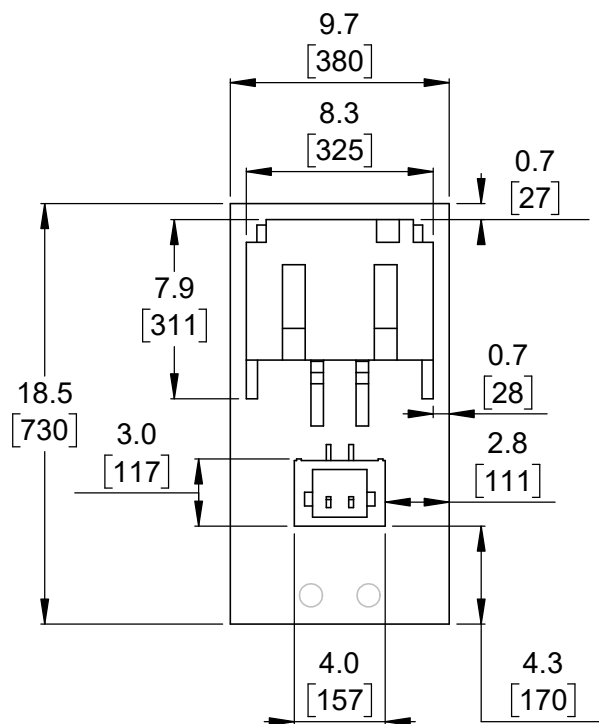

① Board dimensions (top view)
Scale 3:1

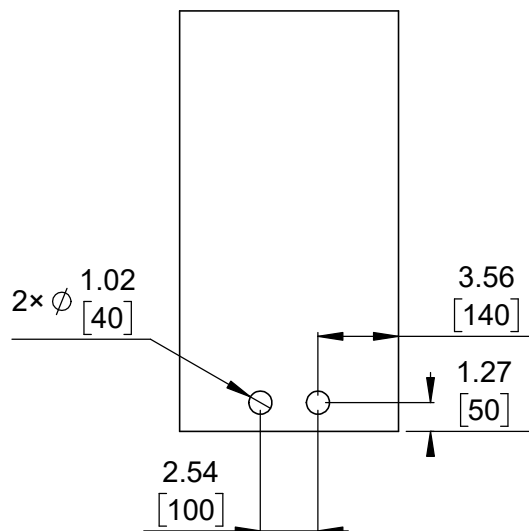

② Connector callouts (bottom view)
Scale 3:1

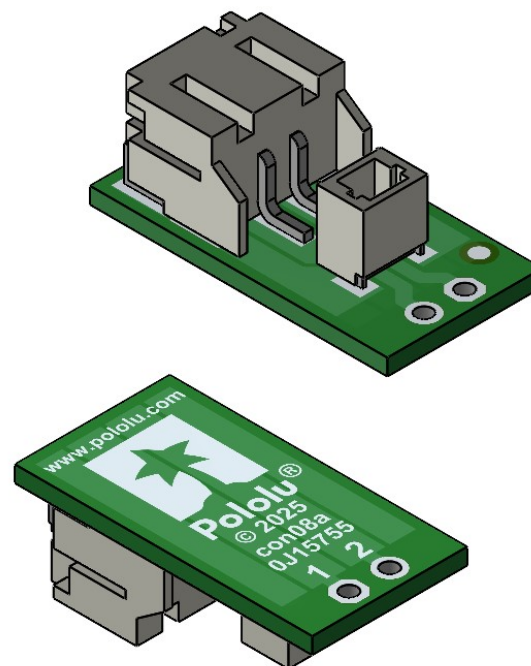

③ Isometric view
Scale 3:1

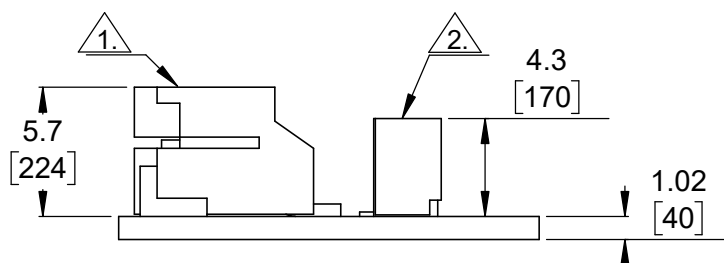

④ Profile
Scale 3:1

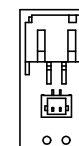

⑤ Actual size
Scale 1:1

1. Side-entry, 2-pin male JST PH-style connector (2.0 mm pitch).
2. Top-entry, 2-pin male JST SH-style connector (1.0 mm pitch).
3. To get the specified scale, select 100% in print settings.
4. Drill location tolerance: ± 0.1 [± 5].
5. Board edge tolerance: ± 0.3 [± 10].

<https://www.pololu.com/product/5651>

Name: Breakout for JST PH-Style Connector, 2-Pin Male Side-Entry, with SH		Item number: 5651
Drawing date: 18 August 2025	Dev code: con08a	 © 2025 Pololu Corporation
Units: mm [mil]	Material: mixed	

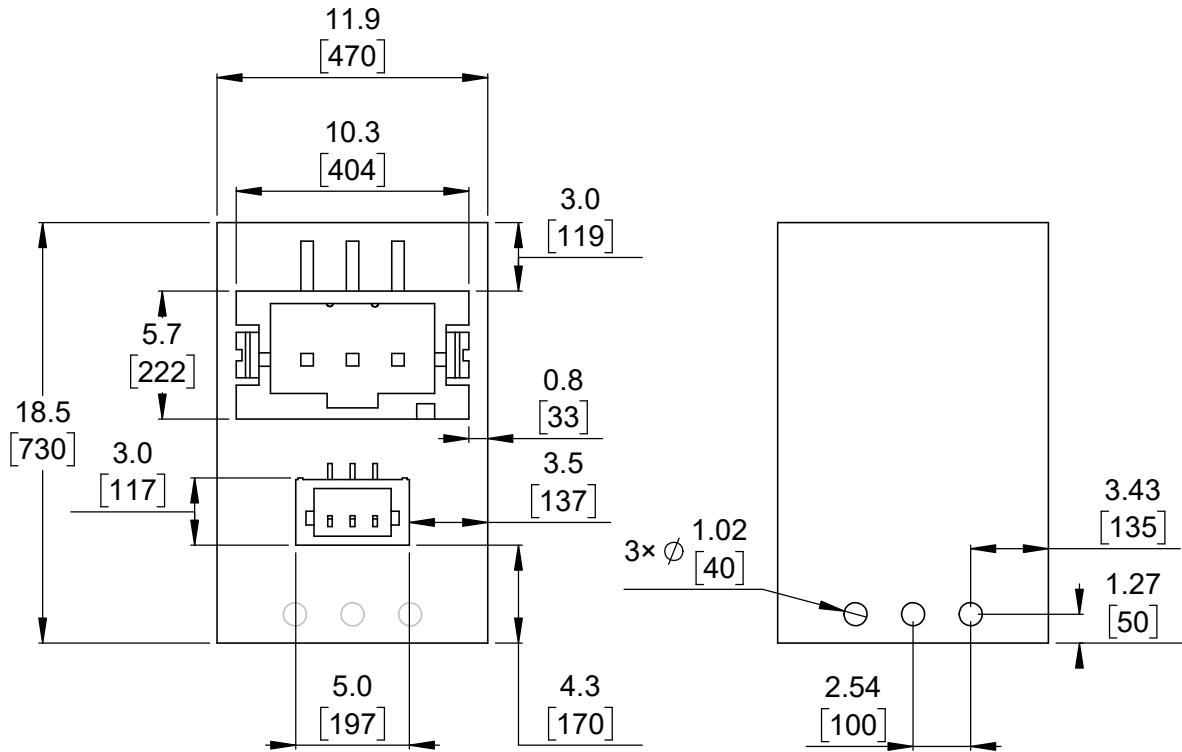

1 Board dimensions (top view)
Scale 3:1

2 Connector callouts (bottom view)
Scale 3:1

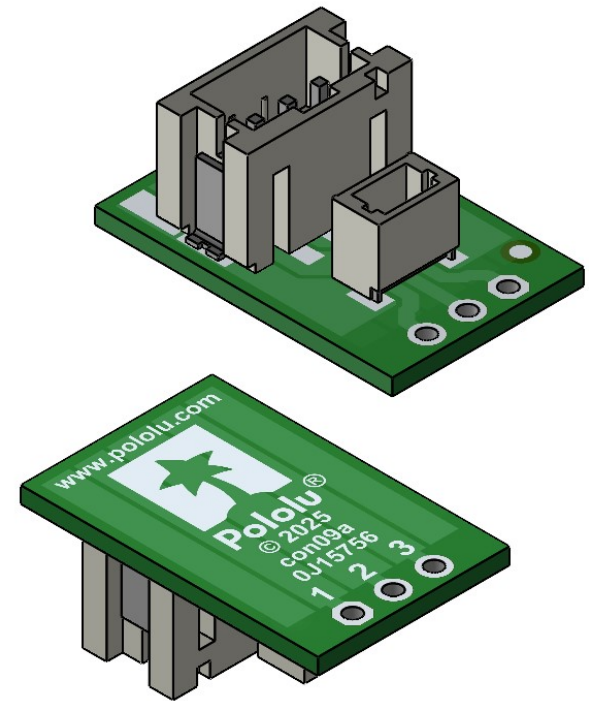

3 Isometric view
Scale 3:1

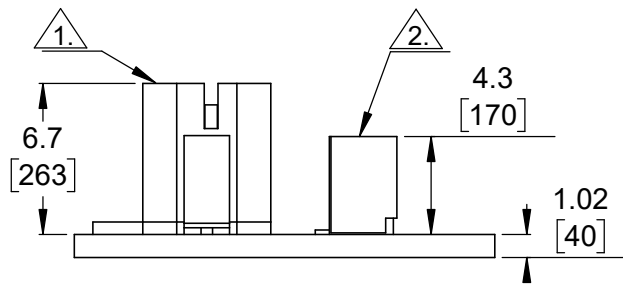

4 Profile
Scale 3:1

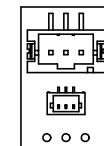

5 Actual size
Scale 1:1

1.

Top-entry, 3-pin male JST PH-style connector (2.0 mm pitch).

2.

Top-entry, 3-pin male JST SH-style connector (1.0 mm pitch).
To get the specified scale, select 100% in print settings.

3.

Drill location tolerance: ± 0.1 [± 5].

4.

Board edge tolerance: ± 0.3 [± 10].

5.

<https://www.pololu.com/product/5652>

Name:

Breakout for JST PH-Style Connector,
3-Pin Male Top-Entry, with SH

Item number:

5652

Drawing date:

18 August 2025

Dev code:

con09a

Units: mm
[mil]

Material:
mixed

Pololu
Robotics & Electronics
© 2025 Pololu Corporation

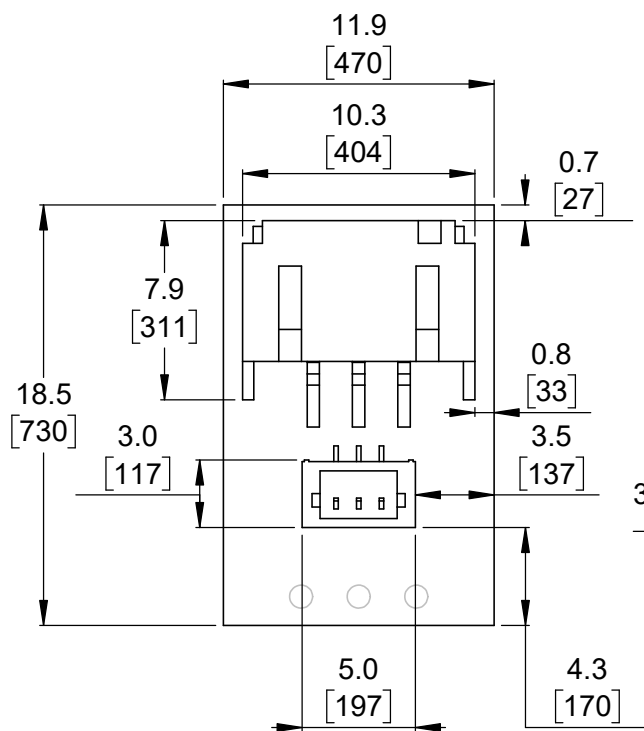

① Board dimensions (top view)
Scale 3:1

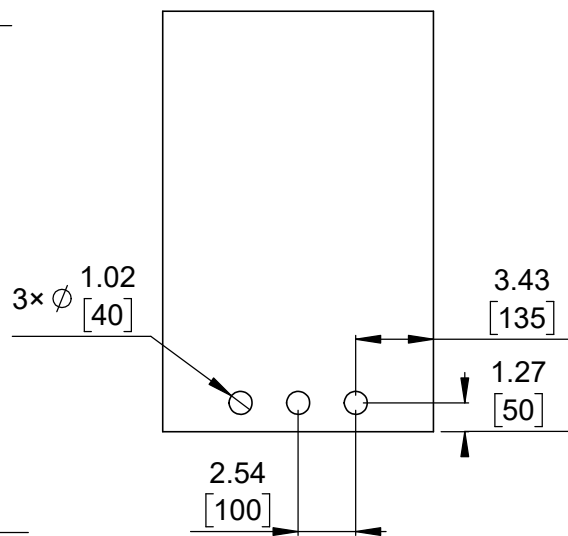

② Connector callouts (bottom view)
Scale 3:1

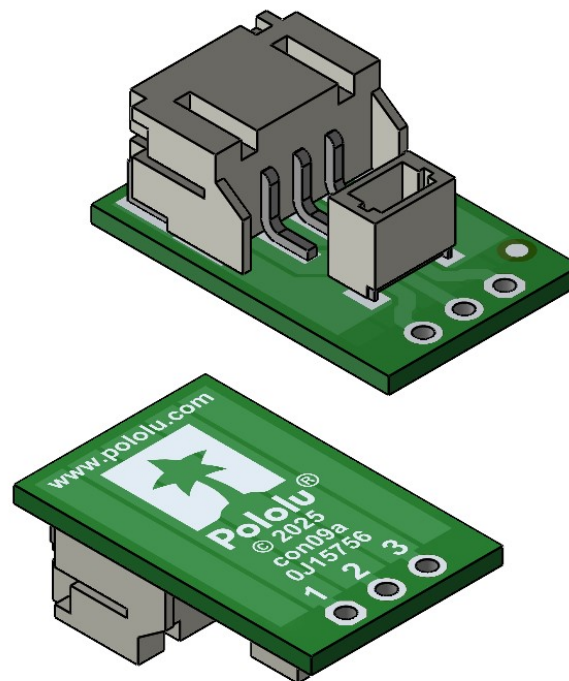

③ Isometric view
Scale 3:1

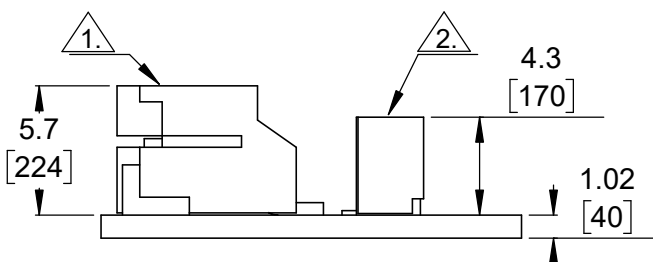

④ Profile
Scale 3:1

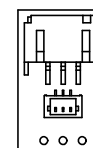

⑤ Actual size
Scale 1:1

①. Side-entry, 3-pin male JST PH-style connector (2.0 mm pitch).

②. Top-entry, 3-pin male JST SH-style connector (1.0 mm pitch).
3. To get the specified scale, select 100% in print settings.

4. Drill location tolerance: ± 0.1 [± 5].

5. Board edge tolerance: ± 0.3 [± 10].

<https://www.pololu.com/product/5653>

Name:
Breakout for JST PH-Style Connector,
3-Pin Male Side-Entry, with SH

Item number:
5653

Drawing date:
18 August 2025

Dev code:
con09a

Units: mm
[mil]

Material:
mixed

Pololu
Robotics & Electronics
© 2025 Pololu Corporation

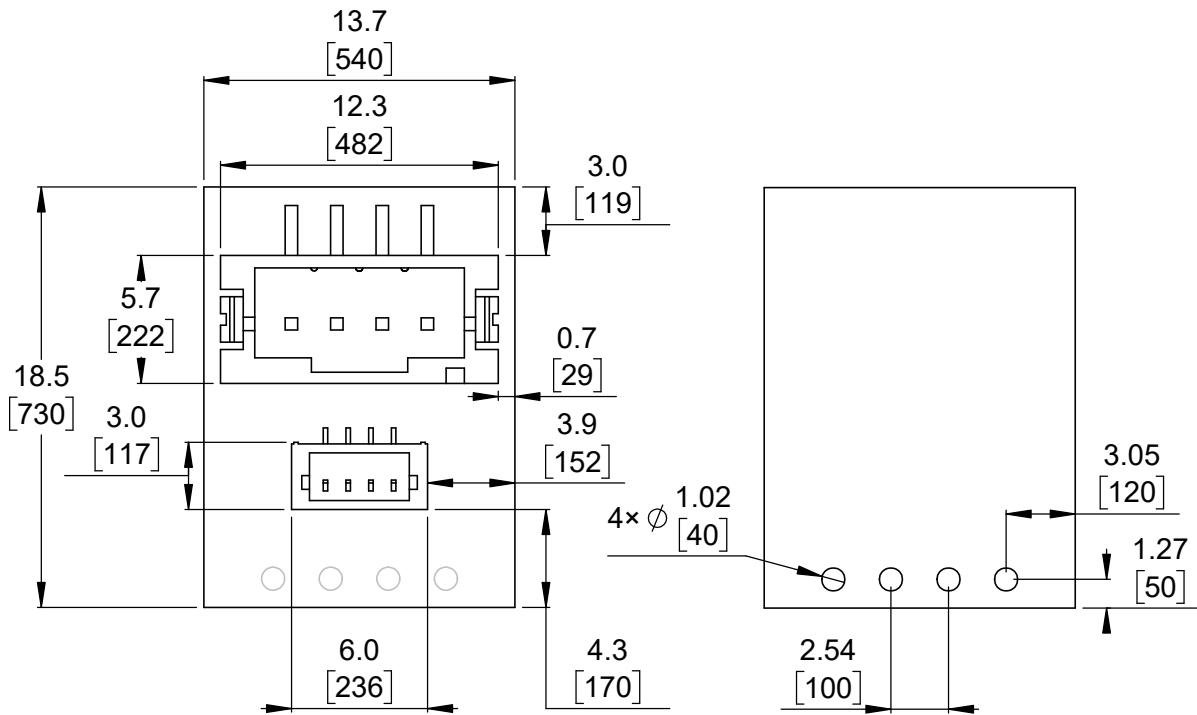

1 Board dimensions (top view)
Scale 3:1

2 Connector callouts (bottom view)
Scale 3:1

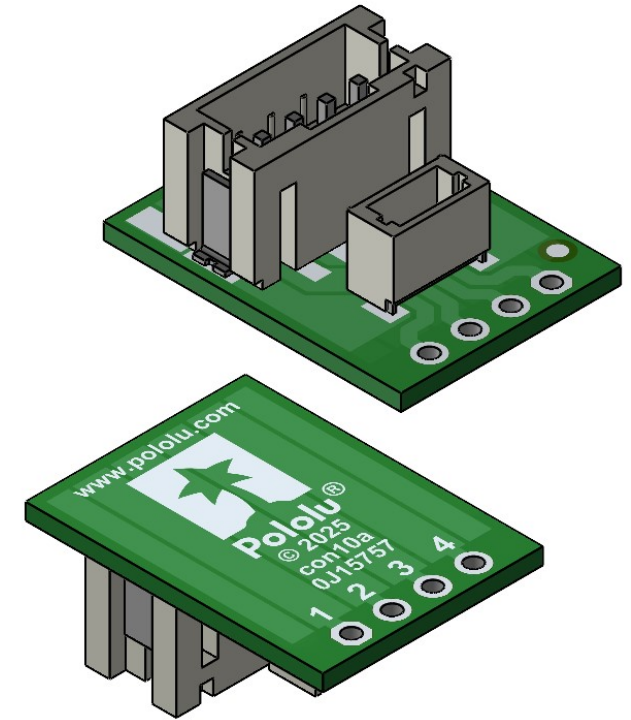

3 Isometric view
Scale 3:1

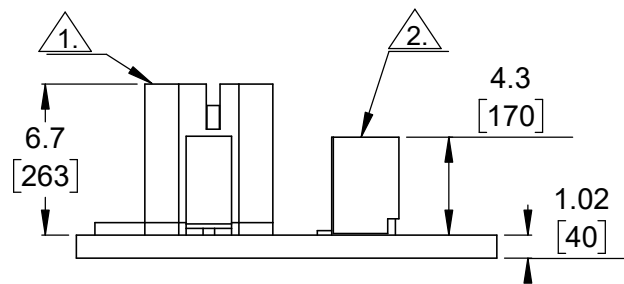

4 Profile
Scale 3:1

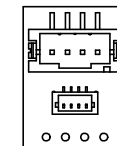

5 Actual size
Scale 1:1

1.

Top-entry, 4-pin male JST PH-style connector (2.0 mm pitch).

2.

Top-entry, 4-pin male JST SH-style connector (1.0 mm pitch).
To get the specified scale, select 100% in print settings.

3. Drill location tolerance: ± 0.1 [± 5].
4. Board edge tolerance: ± 0.3 [± 10].

<https://www.pololu.com/product/5654>

Name:

Breakout for JST PH-Style Connector,
4-Pin Male Top-Entry, with SH

Item number:

5654

Drawing date:

18 August 2025

Dev code:

con10a

Units: mm
[mil]

Material:
mixed

Pololu
Robotics & Electronics
© 2025 Pololu Corporation

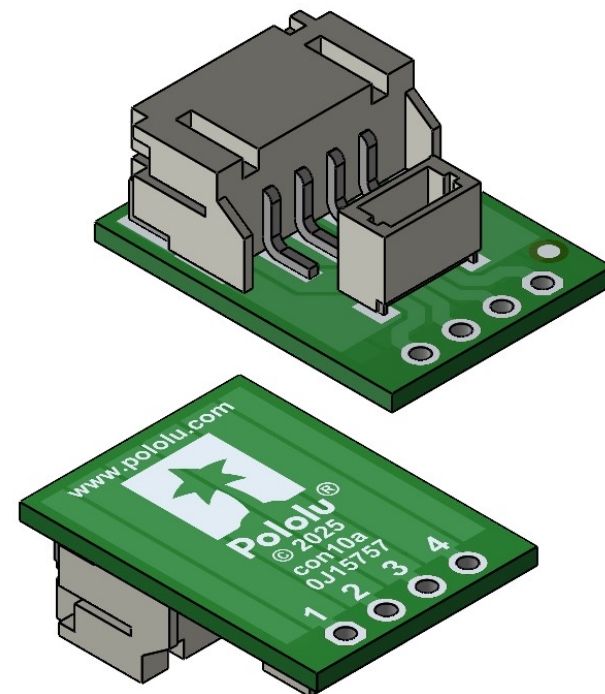

3 Isometric view Scale 3:1

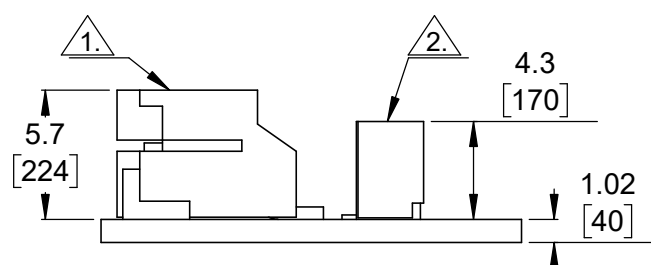

4 Profile Scale 3:1

5 Actual size

Scale 1:1

1. Side-entry, 4-pin male JST PH-style connector (2.0 mm pitch).
2. Top-entry, 4-pin male JST SH-style connector (1.0 mm pitch).
3. To get the specified scale, select 100% in print settings.
4. Drill location tolerance: ± 0.1 [± 5].
5. Board edge tolerance: ± 0.3 [± 10].

https://www.pololu.com/product/5655		
Name: Breakout for JST PH-Style Connector, 4-Pin Male Side-Entry, with SH		Item number: 5655
Drawing date: 18 August 2025	Dev code: con10a	
Units: mm [mil]	Material: mixed	
 © 2025 Pololu Corporation		

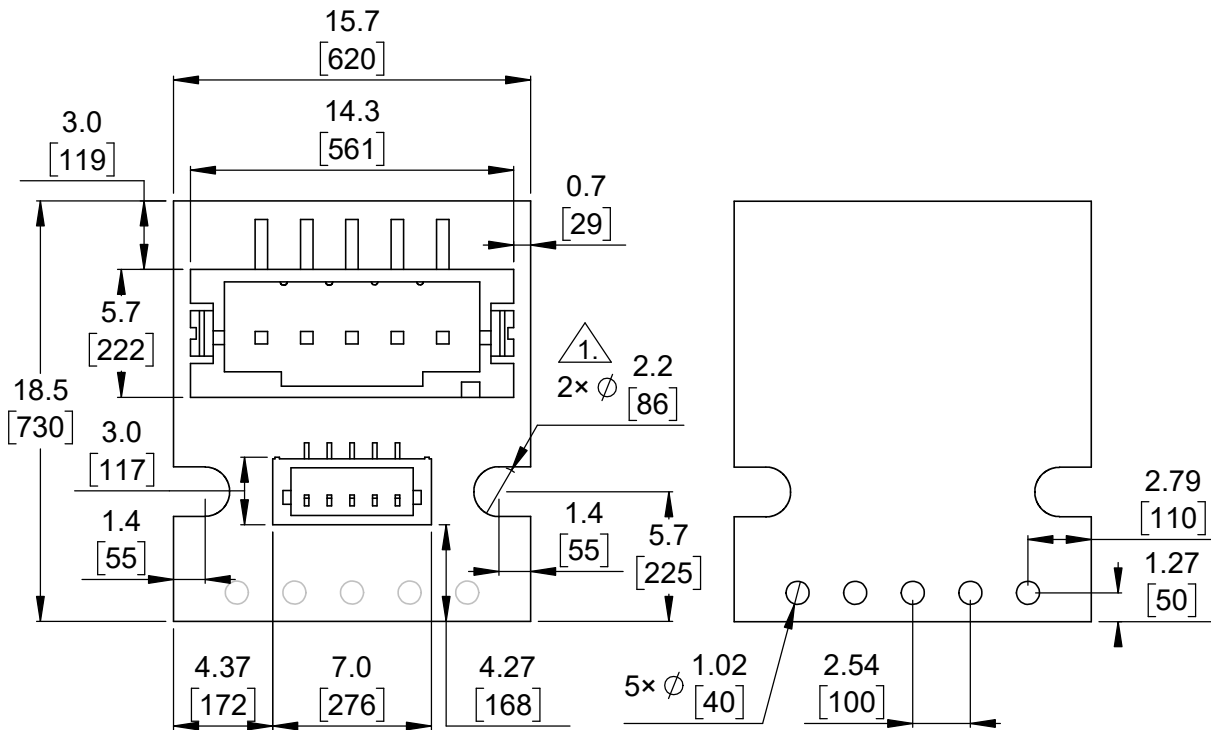

① Board dimensions (top view)
Scale 3:1

② Connector callouts (bottom view)
Scale 3:1

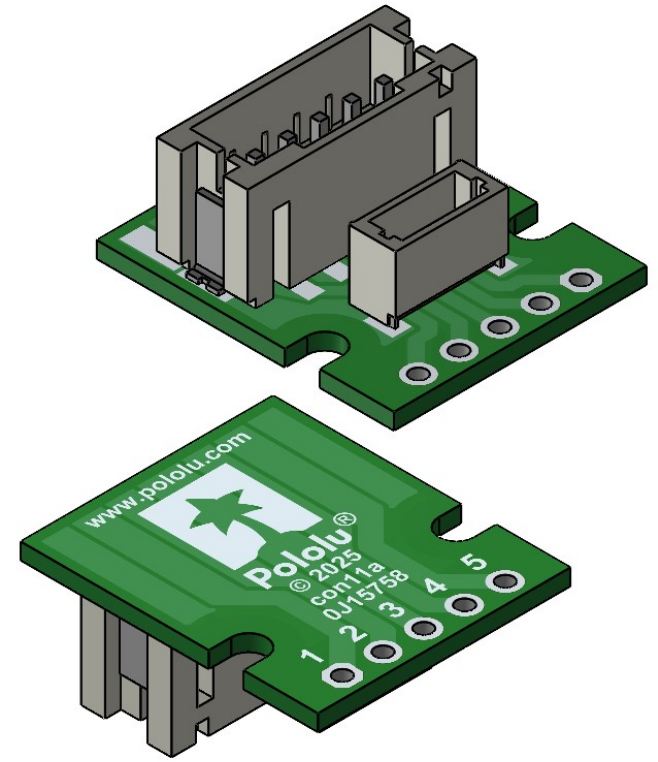

③ Isometric view
Scale 3:1

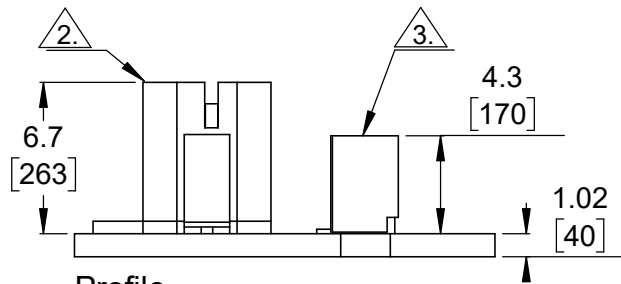

④ Profile
Scale 3:1

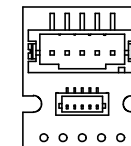

⑤ Actual size
Scale 1:1

- ①. Intended for #2 and M2 screws.
- ②. Top-entry, 5-pin male JST PH-style connector (2.0 mm pitch).
- ③. Top-entry, 5-pin male JST SH-style connector (1.0 mm pitch).
To get the specified scale, select 100% in print settings.
4. Drill location tolerance: ± 0.1 [± 5].
5. Drill location tolerance: ± 0.1 [± 5].
6. Board edge tolerance: ± 0.3 [± 10].

<https://www.pololu.com/product/5656>

Name: Breakout for JST PH-Style Connector, 5-Pin Male Top-Entry, with SH		Item number: 5656
Drawing date: 18 August 2025	Dev code: con11a	 © 2025 Pololu Corporation
Units: mm [mil]	Material: mixed	

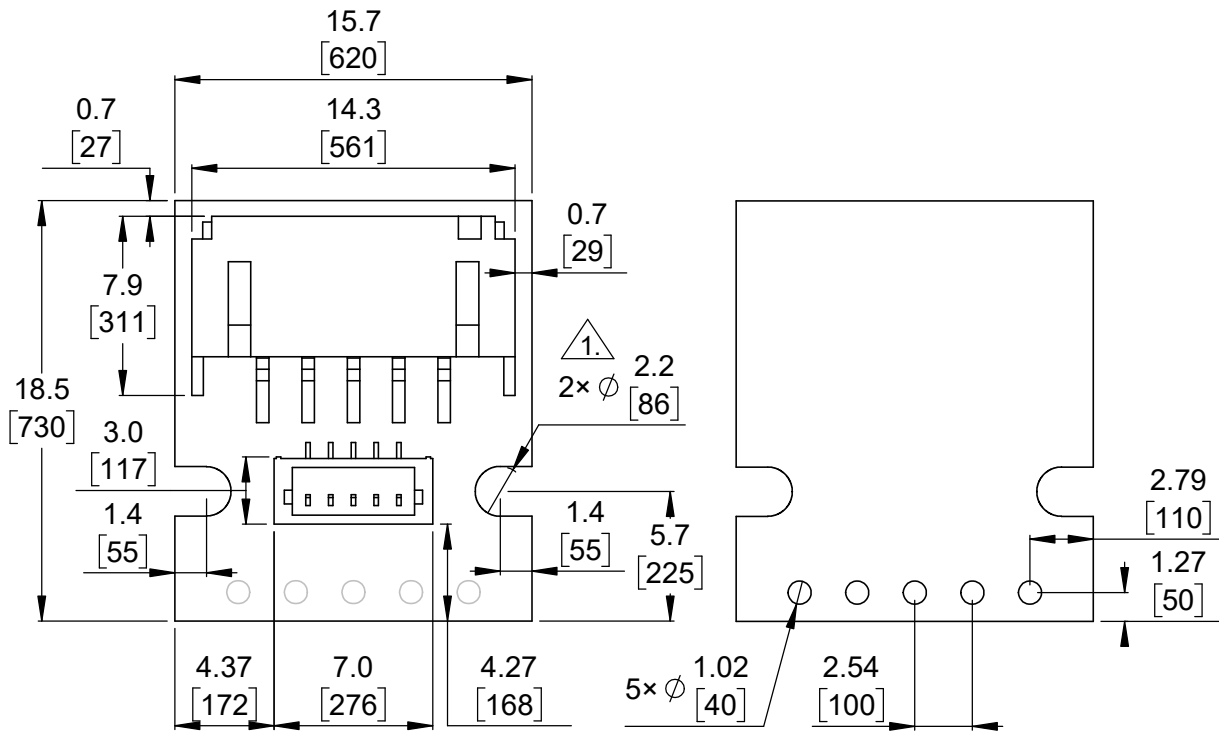

① Board dimensions (top view)
Scale 3:1

② Connector callouts (bottom view)
Scale 3:1

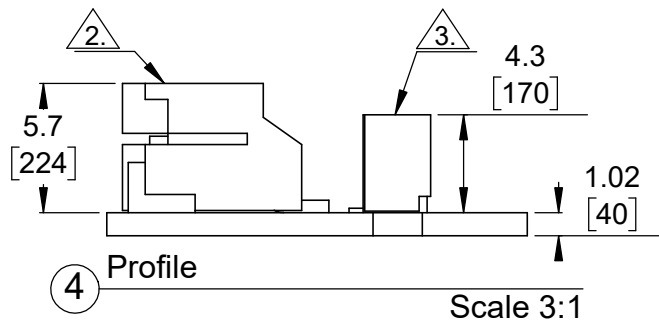

④ Profile
Scale 3:1

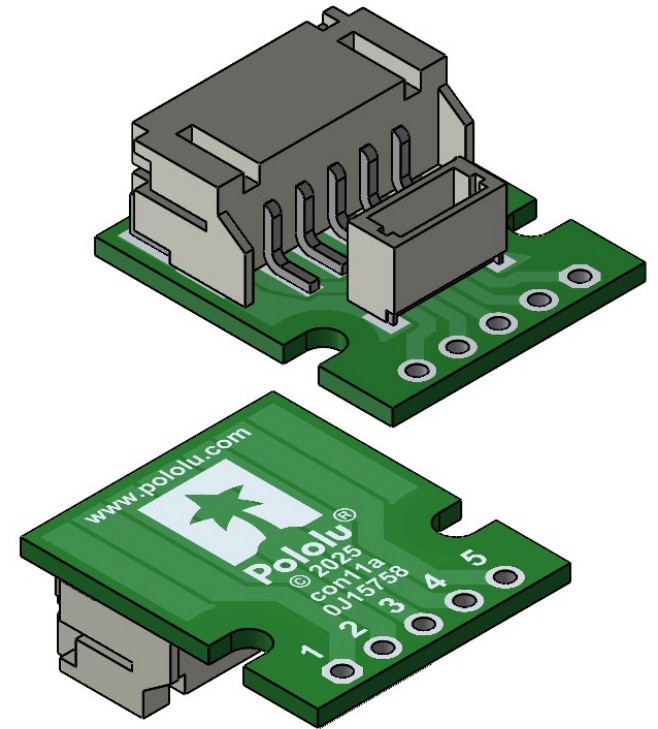

③ Isometric view
Scale 3:1

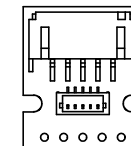

⑤ Actual size
Scale 1:1

- ①. Intended for #2 and M2 screws.
- ②. Side-entry, 5-pin male JST PH-style connector (2.0 mm pitch).
- ③. Top-entry, 5-pin male JST SH-style connector (1.0 mm pitch)..
To get the specified scale, select 100% in print settings.
4. Drill location tolerance: ± 0.1 [± 5].
5. Board edge tolerance: ± 0.3 [± 10].

<https://www.pololu.com/product/5657>

Name: Breakout for JST PH-Style Connector, 5-Pin Male Side-Entry, with SH		Item number: 5657
Drawing date: 18 August 2025	Dev code: con11a	 © 2025 Pololu Corporation
Units: mm [mil]	Material: mixed	

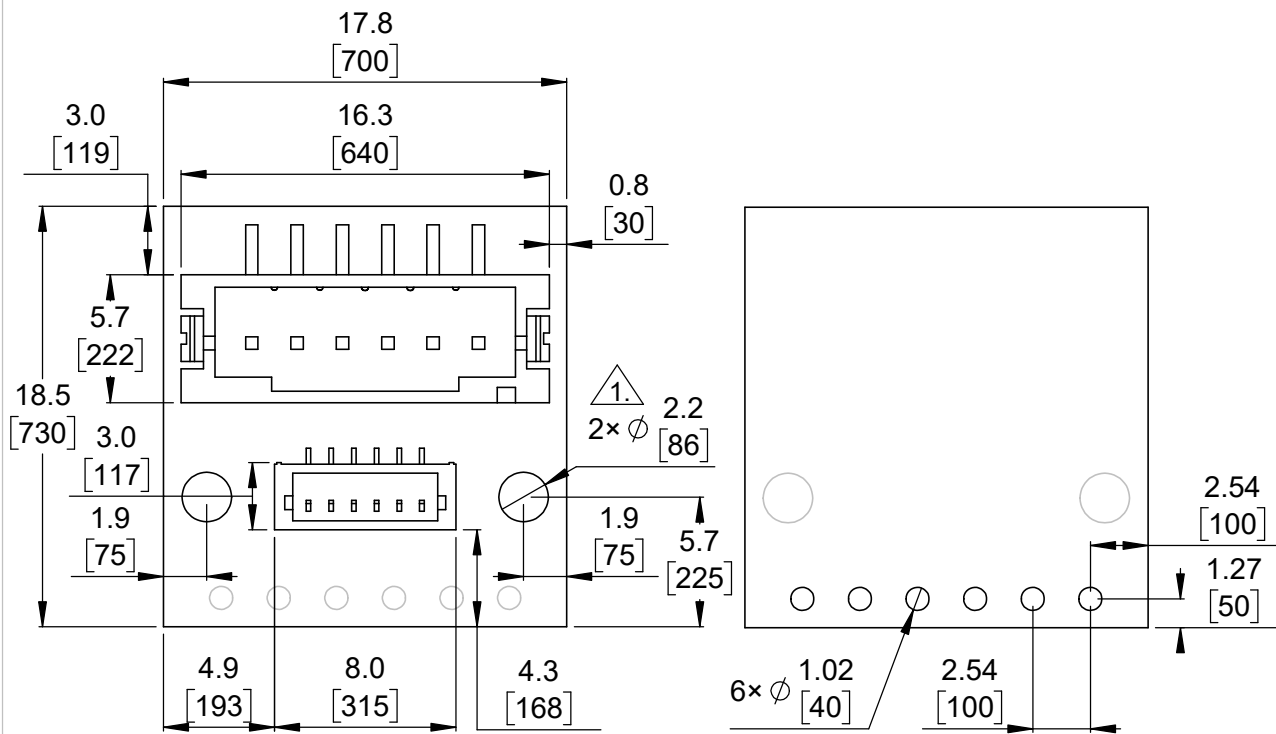

① Board dimensions (top view)
Scale 3:1

② Connector callouts (bottom view)
Scale 3:1

③ Isometric view
Scale 3:1

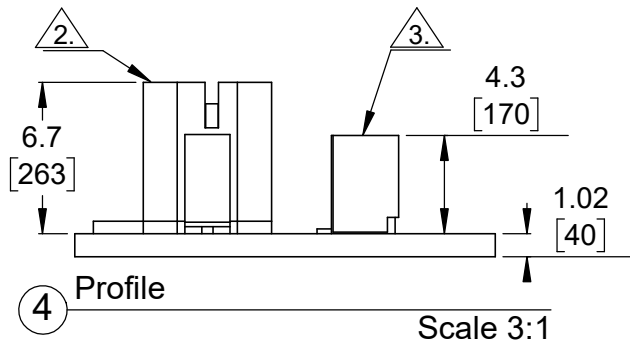

④ Profile
Scale 3:1

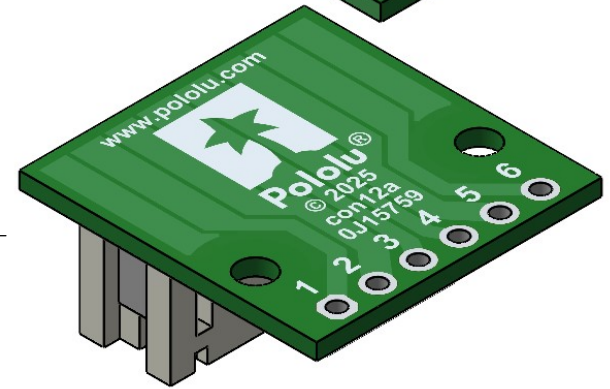

⑤ Actual size
Scale 1:1

- ①. Intended for #2 and M2 screws.
- ②. Top-entry, 6-pin male JST PH-style connector (2.0 mm pitch).
- ③. Top-entry, 6-pin male JST SH-style connector (1.0 mm pitch).
To get the specified scale, select 100% in print settings.
4. Drill location tolerance: ± 0.1 [± 5].
5. Board edge tolerance: ± 0.3 [± 10].

<https://www.pololu.com/product/5658>

Name: Breakout for JST PH-Style Connector, 6-Pin Male Top-Entry, with SH		Item number: 5658
Drawing date: 18 August 2025	Dev code: con12a	 © 2025 Pololu Corporation
Units: mm [mil]	Material: mixed	

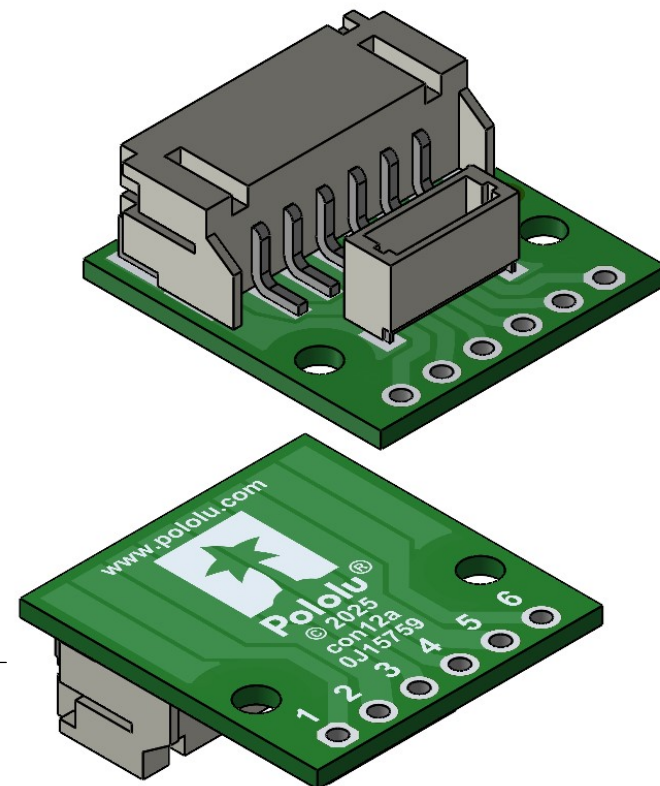

③ Isometric view

Scale 3:1

5 Actual size Scale 1:1

1. Intended for #2 and M2 screws.
2. Side-entry, 6-pin male JST PH-style connector (2.0 mm pitch).
3. Top-entry, 6-pin male JST SH-style connector (1.0 mm pitch).
4. To get the specified scale, select 100% in print settings.
5. Drill location tolerance: ± 0.1 [± 5].
6. Board edge tolerance: ± 0.3 [± 10].

https://www.pololu.com/product/5659		
Name: Breakout for JST PH-Style Connector, 6-Pin Male Side-Entry, with SH		Item number: 5659
Drawing date: 18 August 2025	Dev code: con12a	
Units: mm [mil]	Material: mixed	
 © 2025 Pololu Corporation		